

LOCHAU (AT)



BOAT HOUSE Enhancing the Existing

The proposal reinforces an existing pedestrian axis between town centre and harbour. A road shaded by trees connects the recreation areas of Pfänder Mountain and Lake Constance. From a redesigned intersection at Landstraße, the revitalised Bahnhofstraße passes green spaces and a proposed municipal agricultural coop in the heart of the town, fostering access to commons. At the train station a shared space allows cyclists, motorists and pedestrians to interact safely. The adjoining plaza turns the station into a multi-modal hub, for local trips by bus, a stroll by the lake or interregional journeys. The spirit of the marina is reinvigorated by restoring the Old Ferry through community participation and building a boathouse that doubles up as a cultural space by the lake front.

concept urban development

BOAT HOUSE 1



urban development 1:5000

LOCHAU (AT)

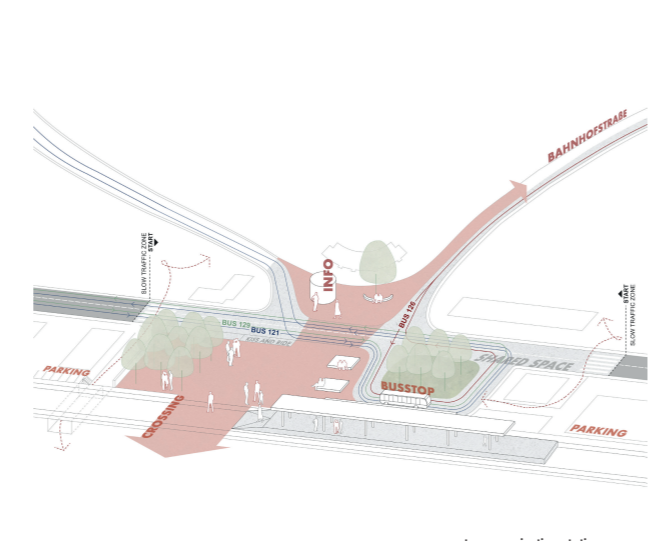

concept reorganisation station square

BOAT HOUSE 2



station square and new rail crossing

LOCHAU (AT)

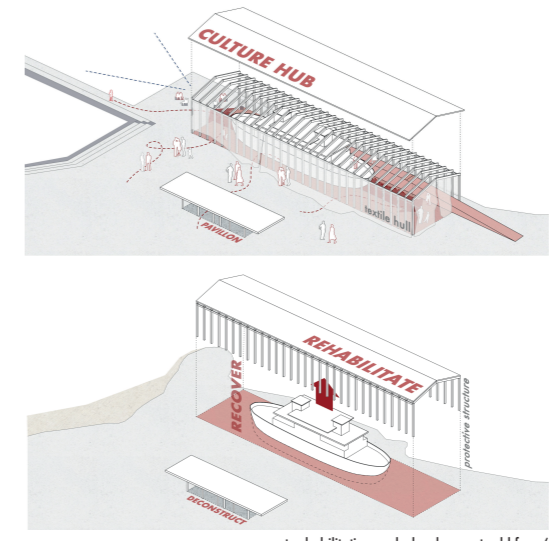

concept rehabilitation and development ,old ferry'

BOAT HOUSE 3



new boat house and ,old ferry'



urban development 1:2500



development harbour 1:750

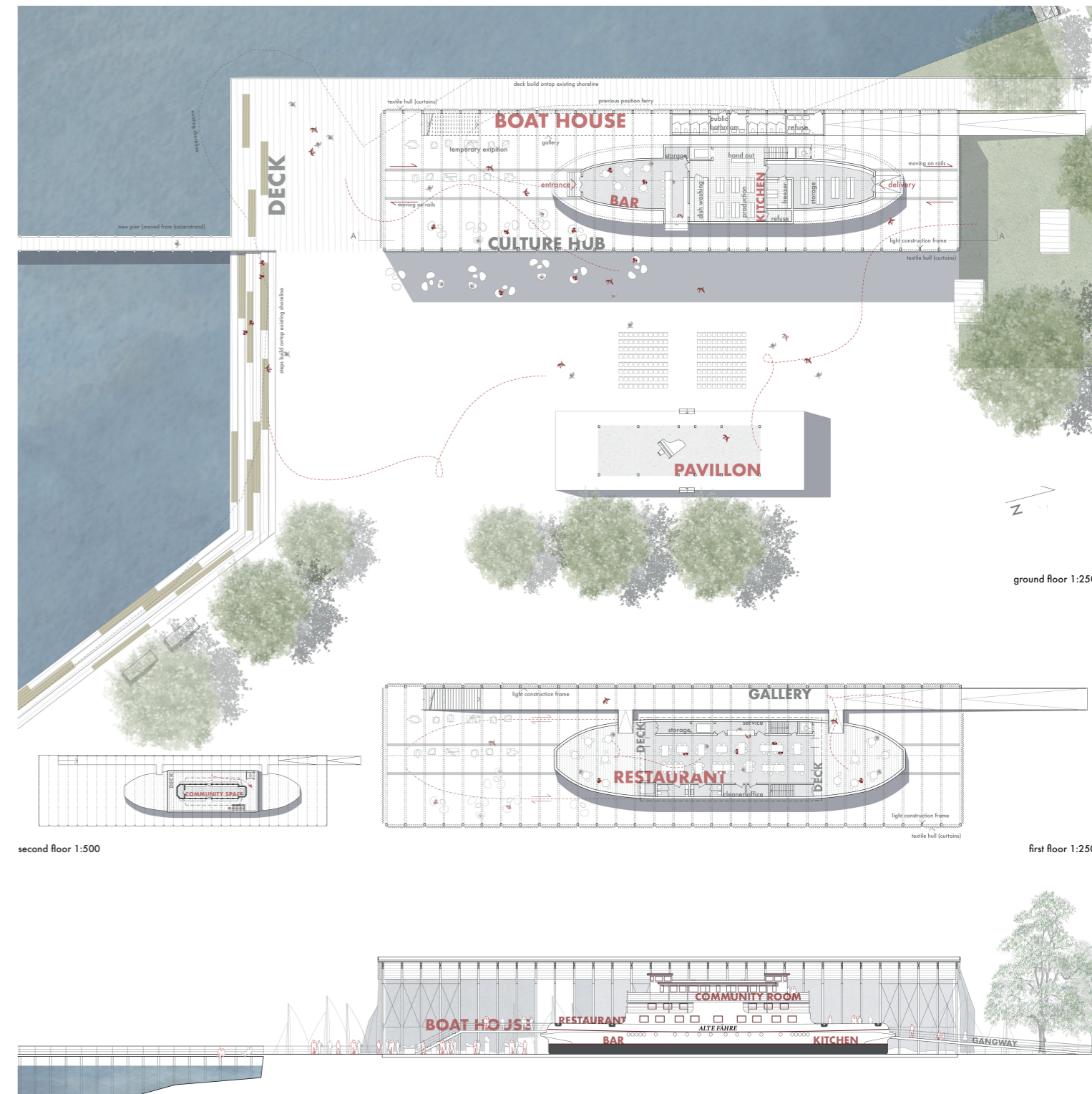

second floor 1:500

first floor 1:250

section 1:250



intersection bahnhofstraße/landstraße

green spaces along bahnhofstraße for community use

infopoint/kiosk opposite train station

PFÄNDER LINK
TOWN CENTRE
WALKABILITY

COMMUNITY CO-OP
SOLIDARITY

COMMONS AGRICULTURE
INFORMATION ORIENTATION
CONNECTIVITY
REFRESHMENT