

# Reveal / Relink / Rebuild

Revealing what was already there

## European 16 Living Cities and Metabolic Vitalities

Recovery & Intensifying Districts

### Levanger (NO)



# Sustainable Urban Development Strategy

**Revealing what was already there is the core concept for the urban revitalisation of the historical town of Levanger. Revealing the existing nature, heritage, entrepreneurialism and social values; and make them work together for the sustainable future of the town in 3 complementary scales:**

- 1 / Regional-scale**, connecting Levanger with its natural surroundings.
- 2 / Urban-scale**, improving mobility and public, walkable and bikeable spaces.
- 3 / Architectural-scale**, creating a new building for the promotion of culture, society and innovation.

**Revealed landscape. Bring nature to the city or bring the city towards nature?**

Levanger is located in an outstanding natural scene where the waters of Levangerelva river meet Trondheimsfjorden, with unique biodiversity also seen in Eidsbotn and the farmlands along the fjords. However, the current urban development has isolated the urban space from its natural surroundings. Thus, a new walkable and cyclable promenade connects Levanger's historical centre and its nearest neighbourhoods directly to its natural context. **Showing the hidden natural value can embrace and leverage consciousness for the rich biodiversity and landscape.**

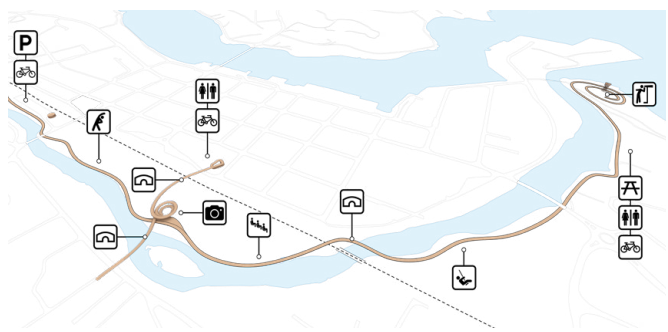

**Relinked heritage. An open-air museum or a livable and dynamic town?**

The protected status of the town should not be a burden for its development but an opportunity to create a quality urban environment that attracts new inhabitants, businesses and innovation. The new urban strategy seeks to maximise an egalitarian and collaborative use of the public space, preserving and leveraging the historical value of the park axis and the town's timber houses. Beyond the physical transformation of the urban space, a "digital urban twin model" called E-Levanger will show up-to-date information about any events in the town, allowing citizens to book or share indoor and outdoor spaces in historical buildings or courtyards for cultural and educational events or check public transport among others.

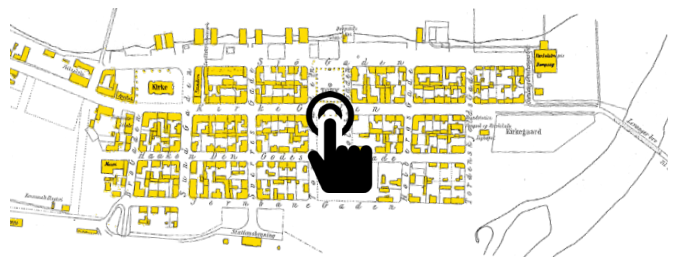

## Rebuilt future Levanger 2030

Levanger has the potential to meet the 2030 Agenda for Sustainable Development by Unesco, and its urban revitalization is an essential part of leading the town to achieve it. The new urban strategy for Levanger is strongly linked with 4 of the Sustainable Development Goals concerning an equalitarian, collaborative and economically prosperous city; and the protection and promotion of land and water biodiversity. Therefore, Levanger 2030 will be a focus of attraction of new businesses and employment, an inclusive and healthy town for all generations and, definitely, a town in harmony with its natural surroundings.



# A New Urban Living Room

***The historical park axis is transformed into the real core of the town, a new urban and inclusive leaving room for Levanger citizens and visitors.***

The revitalization of the historical park of Levanger seeks a reduction of car traffic and an increase of walkable and cyclable areas, improving the urban quality of the area significantly. The project respects and protects the historical traces of the park, preserving most of the trees and green areas. Beyond that, the urban strategy, in addition to regulatory and administrative initiatives, will attract new businesses and entrepreneurs to locate themselves in the city centre. This hypothesis is based on extensive research (see Florida 2002; Glaeser 2010 or Iftikhar, Justice & Audretsch, 2020) upon developing more creative cities to attract young talent to activate the city social and economic vitality.

The project materialises these hypotheses in three complementary ways. First, the redesign of the streets typologies. Second, the proposal for a collaborative and dynamic park that will host the many cultural venues of the town; finally, a covered open square or "agora" connected above the train tracks with the residential area of Ankolm.

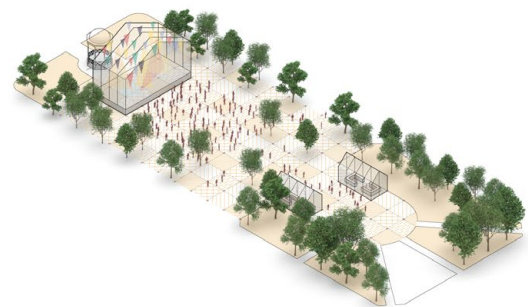
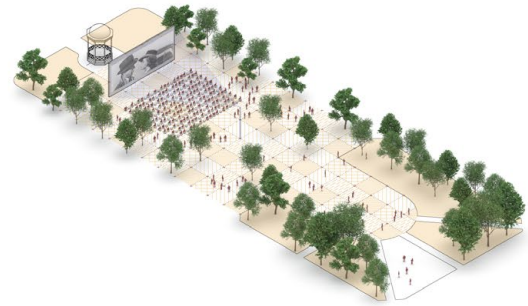

# Media Evolution Hub Culture Centre and Library

*“ A new space for culture, events, social relations, learning, entrepreneurialism and innovation. Beyond a new public facility, the project aims to make Levanger the new hub for media production in Norway, joining together tradition and heritage, with economic and knowledge prosperity”*

**Connection, expansion, activation.** Three main concepts define the new library and cultural hub for the town:

**1 / Connection of the railway infrastructure with the historical park axis.** The volumetry of the building reveals a natural urban connection between the train station and Levanger's historical park.

**2 / Program typology and expansion towards the public space.** The ground floor of the building is conceived as an open and flexible multipurpose program with the capacity to be extended outdoors. Thus, activating its immediate surroundings and leveraging the urban quality.

**3 / Culture and knowledge: Levanger's identity.** The library is located on the upper level at the same height as the town hall. A new urban reference for the promotion of culture and knowledge.

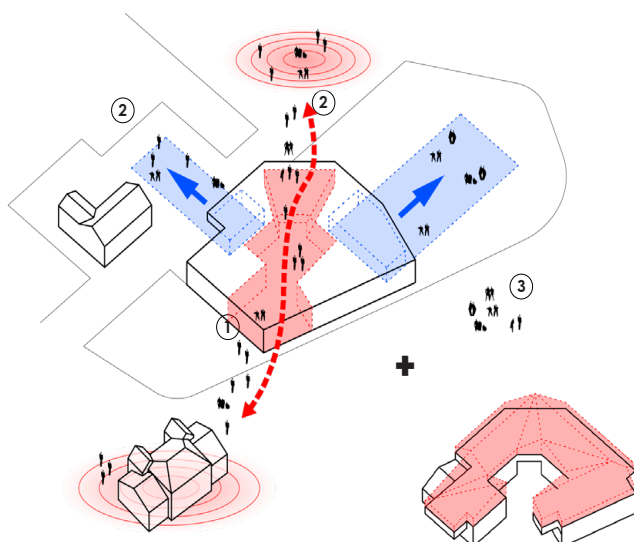

## **Tradition & Innovation.** How do we merge tradition and innovation?

The new building construction system is based on the interpretation of the traditional construction timber systems of Levanger, seeking to create a building that relates and integrates into the currently listed heritage site. While promoting local employment and crafts, technology and industrialised manufacturing processes will reduce the project's carbon footprint, optimise the construction process, and adjust the budget to the needs of Levanger's citizens.

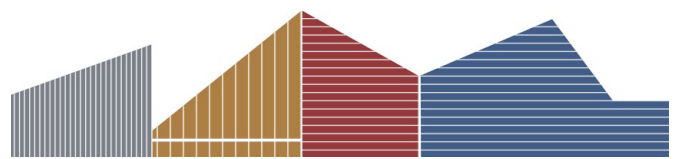

**Carbon footprint and sustainability.** The negative emissions of timber construction not only compensate the other materials of the building such as concrete, but it also compensates the CO2 emissions of 112 fuel cars.

\* Example based on an average of 10.000km/year emitting 120g of CO2 per km. Resulting 1.800 kg of CO2 per car annually

**Step by step transformation.** The area of the new library and cultural centre of Levanger is conceived in two different phases.:

**Phase 1 /** The first phase conceives the new town library and cultural centre, an underground parking for 102 cars, and the renovation of the town hall back courtyard as the a "square for arts".

**Phase 2 /** The second phase includes constructing the covered agora or stage and the walkable/ cyclable bridge promenade that connects the park city axis with the residential area of Ankolm above the river and the rail tracks. Finally, an optional extension of the underground parking for 97 cars can be developed.

