



A new urban artery is created, carefully blending urban and natural activities to organize Rimbo's future growth dynamically. This clear urban gesture harmoniously combines the advantages of a dense, compact lifestyle with the qualities of living in a Garden City. The interaction between this new main street and the multifunctional hub, the "new town hall", creates a stimulating collective image, representing The Rimbo Spirit with authenticity.

A happy cultural landscape, fostering a peaceful and open society in harmony with itself and with nature. Future-proof ecologies will cultivate a living environment that doesn't exploit its context but actively nurtures it. Implemented in phases, this project will transform Rimbo into a vibrant town, offering diverse mixed-use spaces that cater to a wide range of activities, functions, and people. Embracing various building typologies, dimensions, tenures, and affordability levels, the town will be a social space that encourages citizen interaction, stimulates sociability, and strengthens collective identity.

While the multifunctional hub holds powerful symbolism to become the town's centre, the true wonders of Rimbo are its inhabitants. People make places and shape new identities. Creating socialization networks is the foundation of building cities. As we endeavour to involve everyone in shaping the world, we demand humanity. The "new town hall" will act as a platform to catalyse initiatives with social and ecological impacts, engaging the citizens of Rimbo in democratic participatory processes.

The main street introduces a continuous urban stream, connecting a diverse collection of public spaces, each with its unique identity. This coherent entity accommodates the fluctuating identities of our contemporary societies. Democracy is equality among the different and, only collectively, can we overcome our greatest challenges.



FOLLOW THE YELLOW BRICK ROAD



A clear structure: RINGBO
Rimbo currently lacks a clear structure and urban hierarchy. A ring that encircles the central Garden City area is created by taking advantage of the voids generated by the waterfront in the South, the burying of electrical lines in the West and the old railway in the East.



Nodes with large-scale town facilities are created in the intersections with the main roads and infrastructure.
All other neighbourhood-scale programs are placed along the ring.

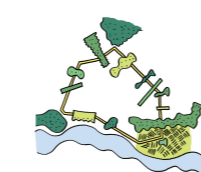

The ring will be a biodiversity corridor, connecting diverse transversal natural spaces and reducing the car mobility.
Nature and culture will be embedded into the urban fabric.



The ring will concentrate dense housing developments providing a wider range of lifestyles.
Each development will have direct access to nature and proximity to social facilities.

An open system for diversity

The ring connects all scales and provides a structure for densification and for human-scale proximity. It is a clear gesture that maximizes the resilience of the entire town by encouraging maximum biodiversity and a variety of programs and lifestyles.

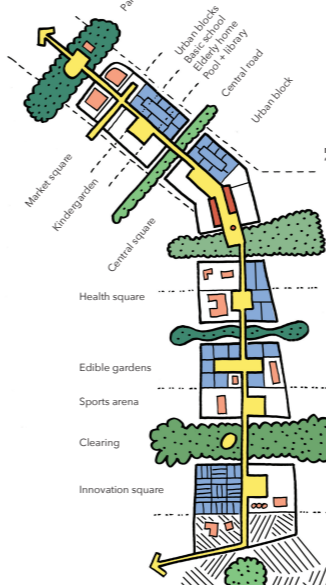

A backbone for vibrant life

Green-blue transversal connections intersect with the main street organizing and segmenting the urban fabric into distinct Superblocks. Each Superblock allows for a different style of living, always following the Garden City principles while adapting to higher density models.

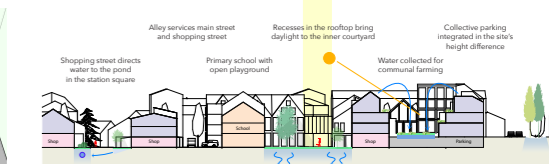

S1. The new densified centre: urban blocks with both collective and private green



S2. The densification of Centralvägen

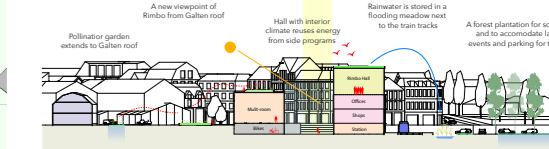

S3. The multifunctional transport hub

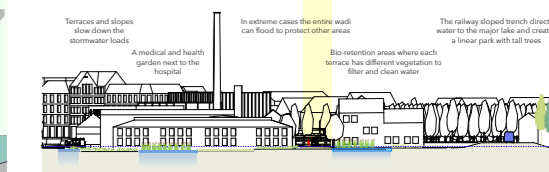

S4. The wadi, a green-blue corridor

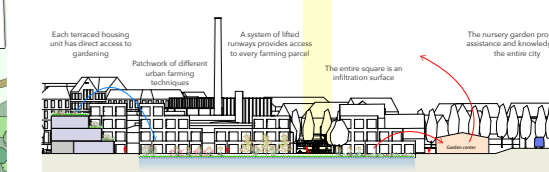

S5. The Urban Village in an edible garden

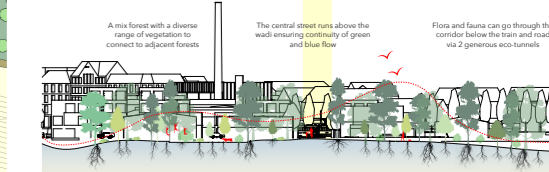

S6. The connecting, mix forest

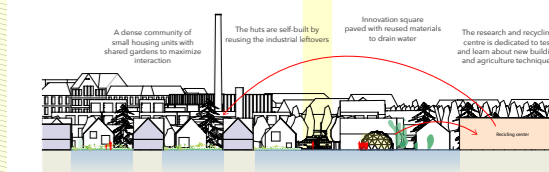

S7. The community hubs and the Recycling Centre

RINGBO is an ongoing process, never truly finished in design, implementation, or management. It remains flexible, responding to the changing needs and desires of its residents. This requires an inclusive planning process with extensive input from the people involved, encouraging participatory democracy and fostering a vibrant urban life. An open, realistic, and adaptable approach that mobilizes The Rimbo Spirit.

Establishing a dialogue between locals and experts is essential in this open process. The urban superblock system, like any living organism, evolves over time, and sustainable development means embracing openness and adaptability.

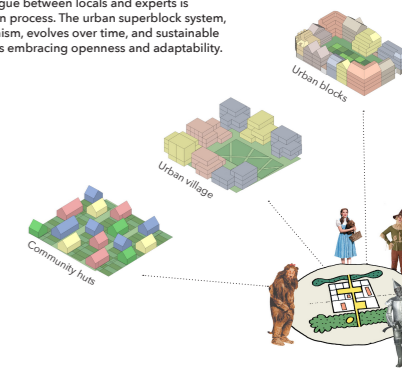

2030 | Road 280 relocates | pop. 7,500



2040 | The train arrives | pop. 10,000



2050 | Road 77 relocates | pop. 12,500

1. Multifunctional hub and new centre
2. Create green transversal corridors
3. Close the ring - place main street along railway
4. Forest plantation behind hub
5. Establish the Recycling Centre
6. Restore old Train Station and connect with park

1. Train station
2. Develop new superblocks behind the railway
3. Develop superblocks
4. Decontaminate soil with green
5. Establish the Recycling Centre
6. Create the connecting mix forest

1. Extend the plots on the centre along old road
2. Transform the forest plantation into urban park
3. Transform the forest plantation into urban park
4. Town Hall becomes a rail town hall
5. The superblocks adapt in density or program

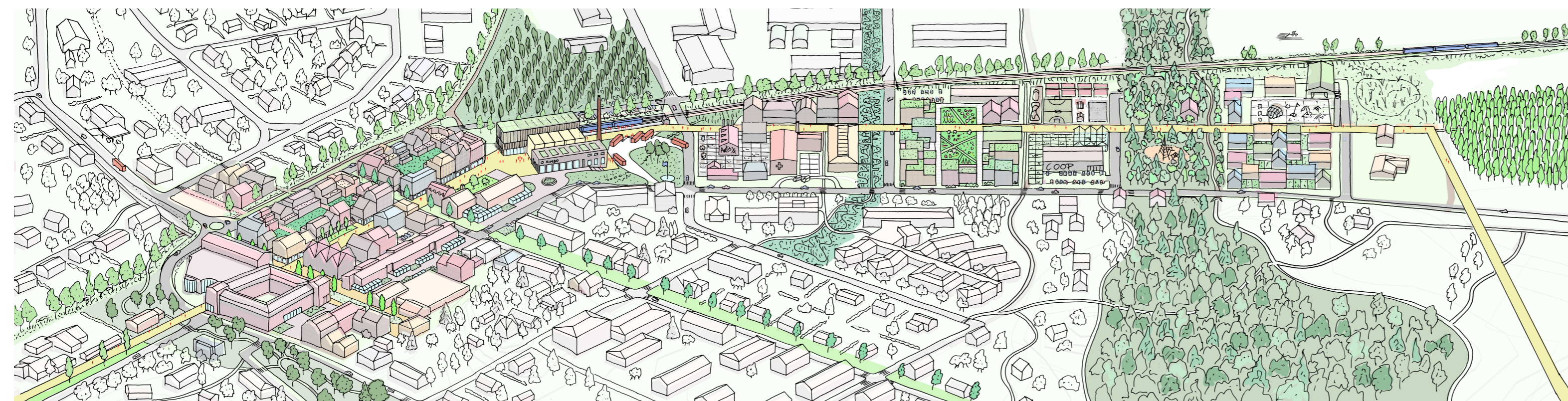

A multifunctional travel centre
The hub combines the characteristic Gatten building and a new wooden structure, blending old and new to establish a fresh identity for Rimbo's centre, while honouring the town's history as a rail hub. The generous openings will allow the programme to activate the public space.



A genuine town hall
In the absence of an actual tower, the new multi-purpose hub will act as the main public building for Rimbo, guaranteeing the social interaction and cohesion of the increasing population.



A welcoming central square
A vibrant central square benefits from the direct connection to the multifunctional hub. The new urban blocks with active plinths create a lively human-scale densified centre, welcoming diverse groups of people who use it simultaneously.



A lively main street
A circular route provides easy access to essential facilities and natural areas by foot or bike. Carefully organized, this diverse sequence of spaces creates an exciting and pleasant journey for everyday life, encouraging people to explore and enjoy Rimbo.